

Anne's White Columns Inn was originally built in 1930 as a Christian Science church. Anne Bahr purchased the church in 1986 and turned it into a 10-room Bed & Breakfast. The maple trees in front of the church were replaced with King Crimson maples, holly bushes were added to flank the entrance, and the cedar hedge between the church and neighboring home were replaced by the Front Corner Garden. The Middle Garden was added in 1993 to serve as a perennial bed for cut flowers. The Patio Garden followed, and was greatly enlarged in 2012.

The Back Border Garden was developed in 1998 as a deep shade garden under the maple trees, with dappled to full sun perennials along the gravel parking area. The Front Garden was planted in 2008 and continues to expand with both perennials and annuals.

We hope you will enjoy our gardens and return often to delight in the new additions each year.

INFO@ANNESWHITECOLUMNS.COM  
207-288-5357 OR 800-321-6379

# COME INTO OUR GARDEN

*of floral delights...*



Anne's  
**WHITE COLUMNS INN**  
BAR HARBOR MAINE  
ANNESWHITECOLUMNS.COM



## FRONT CORNER GARDEN

1. Heliopsis 'Bressingham Doubloon'
2. Iris germanica
3. Myrica pensylvanica
4. Rhododendron catawbiense 'Boursault'
5. Liatris spicata 'Kobold'
6. Baptisia australis
7. Iris siberica 'Snow Queen'
8. Papaver orientale 'Beauty of Livermore'
9. Papaver orientale 'Bolero'
10. Geranium macrorrhizum

11. Sedum 'Fulda Glow'
12. Thymus praecox 'Purple Dwarf'
13. Kalmia latifolia 'Pink Charm'
14. Leucanthemum superbum 'Banana Cream'
15. Delphinium Magic Fountain mix
16. Hosta 'Victory'
17. Astilbe 'New Wave'
18. Peony mix
19. Astilbe 'Jump and Jive'
20. Astilbe radius
21. Iris germanica 'Zeus'

22. Lilium 'Muscadet'
23. Hemerocallis 'Stella de Oro'
24. Phlox subulata 'Emerald Cushion Blue'
25. Dianthus gratianopolitanus 'Bath's Pink'
26. Ilex x meserveae 'Blue Prince'
27. Annuals
28. Euphorbia epithymoides 'First Blush'

*The garden is a love song, a duet between a human being and Mother Nature.*

JEFF COX

Robert Bahr grew up on a farm in Iowa, raised by a father who taught an appreciation for the land, and a mother and grandmother who taught him how to garden. His vision for the gardens at Anne's White Columns Inn includes scented perennials accented with annuals, for color throughout the seasons. Many of the perennials were gifts received from his family and friends, including the guests from his fiftieth birthday party, who were each invited to bring a favorite perennial from their own gardens as a gift (wonderful idea!). Oil painter Tanya Bell joined as head gardener in 2012, and her gifts of color and form are evident throughout the gardens.

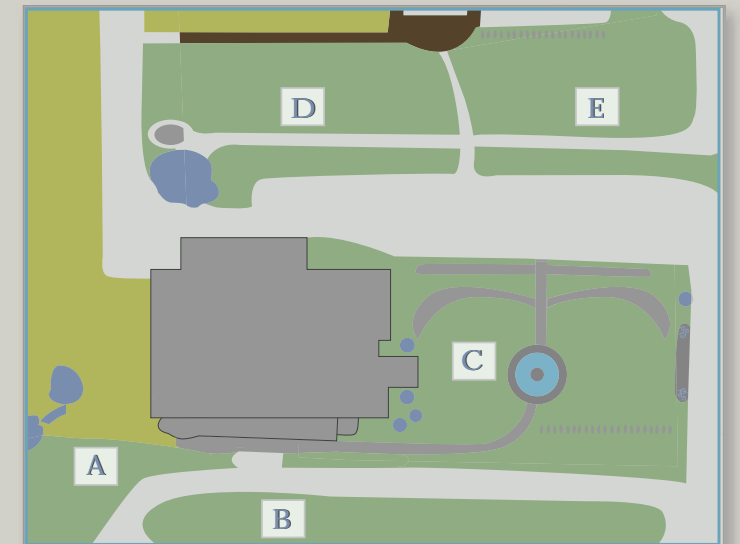

## FRONT GARDEN



- |   |  |                                      |                              |
|---|--|--------------------------------------|------------------------------|
| 1. Penstemon 'Electric Blue'                | 7. Astilbe 'Radius'                            | 12. Hemerocallis 'Stella de Oro'     | 20–21. Hosta                 |
| 2. Iris pseudacorus 'Yellow Flag'           | 8. Astilbe 'Heart and Soul'                    | 13. Astilbe 'New Wave'               | 22. Weigela 'Variegata'      |
| 3. Hosta                                    | 9. Aquilegia vulgaris 'Clementine Dark Purple' | 14. Astilbe 'Diamonds and Pearls'    | 23. Lilium 'Salmon Star'     |
| 4. Dianthus gratianopolitanus 'Bath's Pink' | 10. Liatris spicata 'Kobold'                   | 15–16. Annuals                       | 24. Agastache 'Blue Fortune' |
| 5. Dianthus 'Grandiflorus'                  | 11. Heliopsis 'Bressingham Double'             | 17. Rosa 'Oregold-Hybrid Tea'        | 25. Leucanthemum 'Becky'     |
| 6. Geranium macrorrhizum                    |  | 18. Rosa floribunda 'Rainbow Sorbet' | 26. Astilbe 'New Wave'       |
|   |  | 19. Hemerocallis mix                 | 27–34. Annuals               |

## PATIO GARDEN

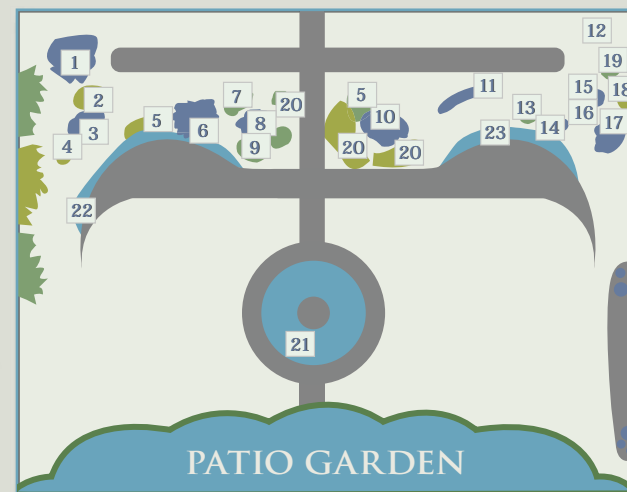

- |                                 |   |
|---------------------------------|---|
| 1. Weigela Florida 'Red Prince' | 5. Echinacea purpurea 'Kim's Knee High' |
| 2. Astilbe 'New Wave'           | 6. Prunus 'Pink Snow Showers'           |
| 3. Pieris 'Brouwer's Beauty'    | 7. Trollius 'Orange Queen'              |
| 4. Centranthus 'Red Valerian'   |   |

*He who has a garden and a library wants for nothing*

MARCUS TULLIUS CICERO

- |  |  |
|--|--|
| 1. Iris sibirica 'Gull's Wing'           | 20. Astilbe chinensis 'Visions'          |
| 2. Helianthus                            | 21. Siberica                             |
| 3. Monarda 'Pink Supreme'                | 22. Hemerocallis mix                     |
| 4. Phlox subulata 'Emerald Cushion Blue' | 23. Aruncus dioicus                      |
| 5. Iris versicolor                       | 24. Astilbe mix                          |
| 6. Filipendula rubra 'Venusta'           | 25. Heuchera 'Christa'                   |
| 7–8. Lillium orientale 'Starfighter'     | 26. Cimicifuga simplex 'Brunette'        |
| 9. Hemerocallis 'Common Orange'          | 27. Digitalis purpurea 'Foxy'            |
| 10. Spiraea japonica 'Little Princess'   | 28. Astilbe 'Red Sentinel'               |
| 11. Annuals                              | 29. Euphorbia polychroma 'Bonfire'       |
| 12. Lobelia siphilitica 'Blue Selection' | 30. Chelone lyonae 'Hot Lips'            |
| 13. Dicentra spectabilis                 | 31. Ligularia stenocephala 'The Rocket'  |
| 14. Hosta                                | 32–33. Astilbe mix                       |
| 15. Hemerocallis mix                     | 34. Digitalis purpurea 'Dalmatian Peach' |
| 16. Centaurea dealbata                   | 35. Ajuga pyramidalis 'Metallica Crispa' |
| 17. Athyrium niponicum 'Pictum'          | 36–37. Annuals                           |
| 18. Nepeta x faassenii 'Walker's Low'    |  |
| 19. Aстранtia 'Star of Beauty'           |  |

## BACK BORDER GARDEN



## MIDDLE GARDEN



- |                                       |  |                                      |  |
|---------------------------------------|--|--------------------------------------|--|
| 1. Acer palmatum 'Fireglow'           | 11. Centaurea montana                    | 19. Phlox paniculata 'David'         | 25. Dianthus gratianopolitanus 'Bath's Pink' |
| 2. Spiraea japonica 'Little Princess' | 12. Geranium macrorrhizum                | 20. Iris sibirica 'Caesar's Brother' | 26. Salvia nemorosa 'May Night'              |
| 3. Prunus 'North Star'                | 13. Malva moschata 'Pink Perfection'     | 21. Iris sibirica 'Gull's Wing'      | 27. Geranium 'Johnson's Blue'                |
| 4. Rhododendron P.J.M.                | 14. Heliopsis 'Summer Sun'               | 22. Delphinium Magic Fountain mix    | 28–34. Annuals                               |
| 5. Alchemilla mollis                  | 15. Pulsatilla vulgaris                  | 23. Heliopsis 'Bressingham Double'   | 29. Aruncus dioicus                          |
| 6. Sedum 'Autumn Joy'                 | 16. Cosmos                               | 24. Echinacea 'Summer Sky'           | 30. Phlox subulata 'Emerald Cushion Blue'    |
| 7. Monarda 'Jacob Cline'              | 17. Hibiscus syriacus 'Rose Satin'       |                                      |  |
| 8. Helenium 'Red Army'                | 18. Lychnis x arkwrightii 'Orange Dwarf' |                                      |  |
| 9. Helenium 'El Dorado'               |  |                                      |  |
| 10. Helenium 'Ruby Charm'             |  |                                      |  |

*A garden isn't meant to be useful. It's for joy.*

RUMER GODDEN